

↓	⌢
HBC-28/15	PEC-TA-28/15
HBC-38/17	PEC-TA-38/17
HBC-40/22	PEC-TA-40/22, PEC-TA-40/22-P, PEC-TA-40/25
HBC-50/30	PEC-TA-49/30, PEC-TA-50/30, PEC-TA-50/30-P PEC-TA-52/34, PEC-TA-54/33

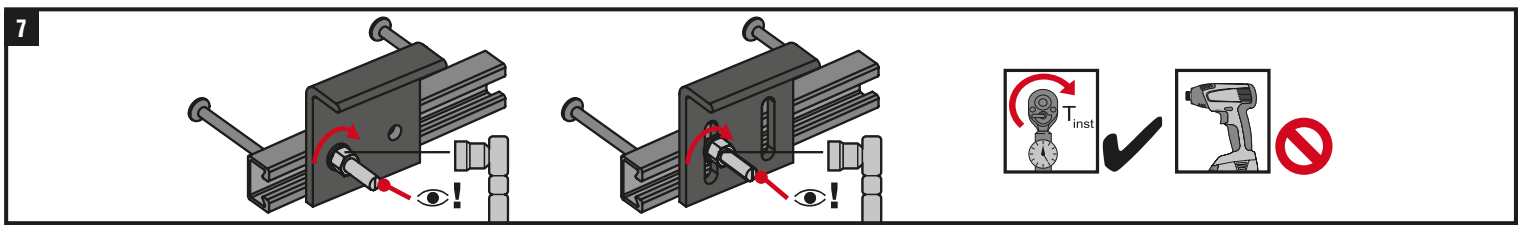
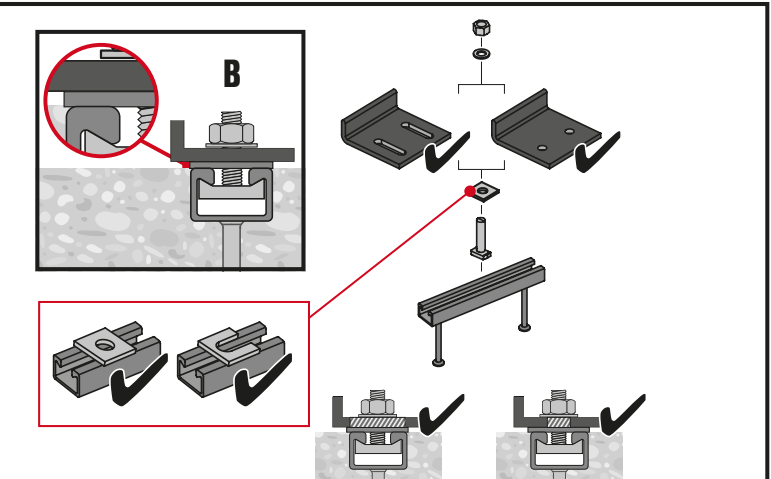
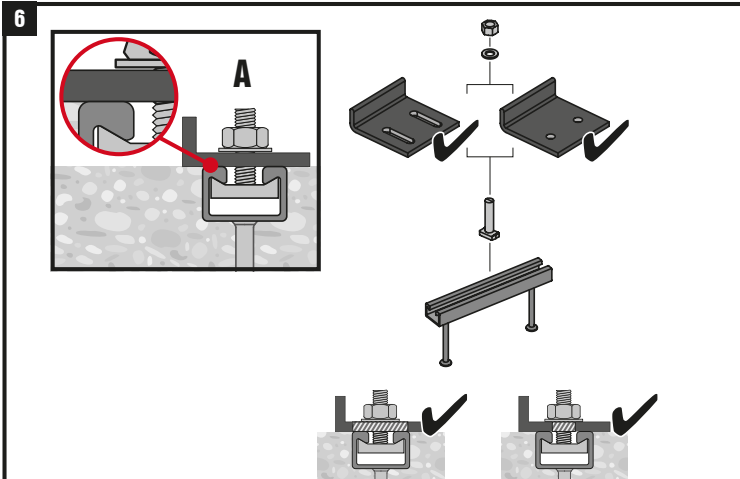
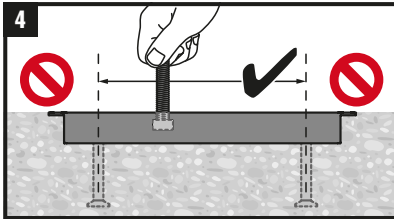
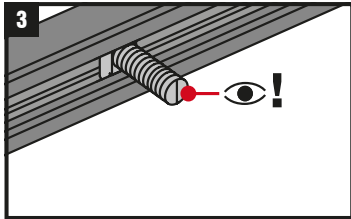
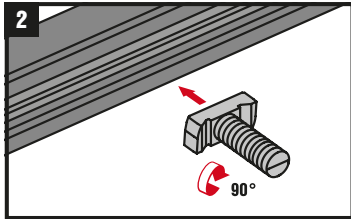
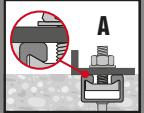
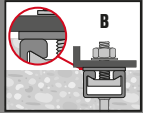

Channel bolt		$T_{inst}$ (Nm) <sup>1)</sup>				
						
		4.6, 8.8, A4-50, A4-70	4.6	8.8	A4-50	A4-70
HBC-28/15	M8	7	-	20	7	15
	M10	10	-	40		30
	M12	13	-	60		50
HBC-38/17	M10	15	13	15	-	22
	M12	25	-	45		50
	M16	40	-	100		90
HBC-40/22	M10	15	13	15	-	22
	M12	25	-	45		50
	M16	30	-	100		90
HBC-50/30	M12	25	-	45	-	50
	M16	55	-	100		130
	M20	55	-	360		250

<sup>1)</sup>  $T_{inst}$  must not be exceeded